



OFFERS OVER

£705,000

Sutton Road

Hounslow, TW5 0PF

PROPERTY SUMMARY

A well-presented three-bedroom detached house situated on a generous plot along Sutton Road in Heston. This spacious property offers excellent potential for further extension (subject to planning permission), making it an ideal opportunity for families.

The ground floor comprises two bright and versatile reception rooms, a separate kitchen, and an extended dining area overlooking the substantial rear garden. To the first floor, there are three well-proportioned bedrooms and a family bathroom.

Externally, the property benefits from ample off-street parking and an impressive rear garden extending over 100 feet, providing plenty of space for outdoor entertaining or future development.

Offered to the market with no onward chain, this is a fantastic opportunity to acquire a home with both immediate comfort and long-term potential.

3



1



2





Sutton Road, Heston

Approximate Gross Internal Area
1152 sq ft - 107 sq m

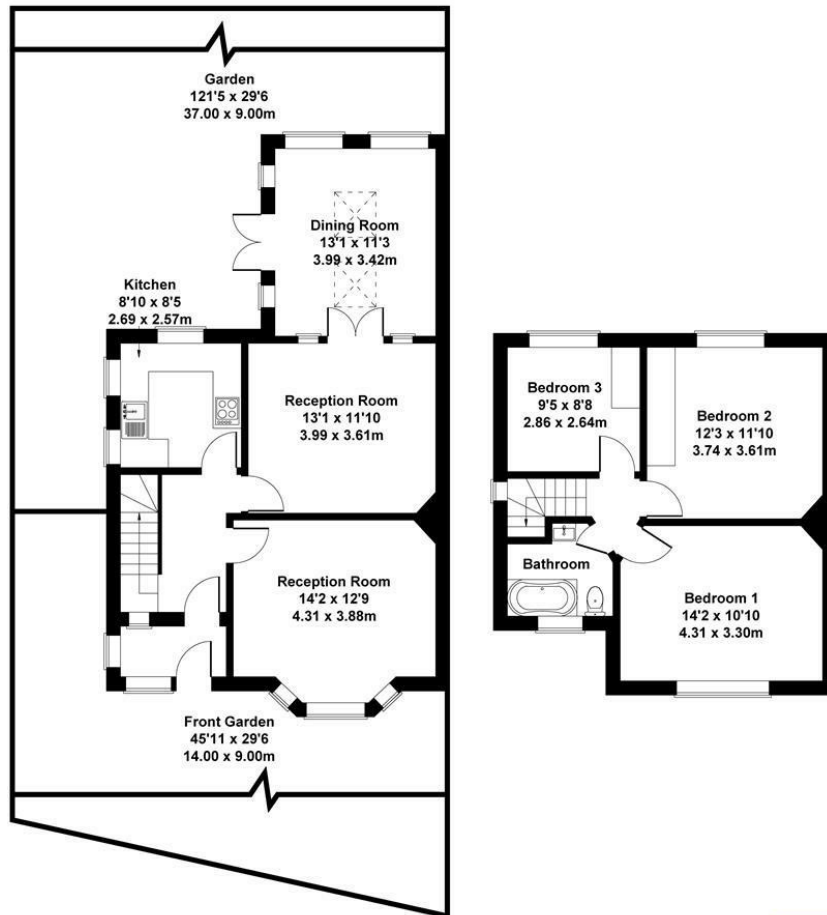

GROUND FLOOR

FIRST FLOOR

Not to Scale. Produced by The Plan Portal 2026
For Illustrative Purposes Only.

Shaw
& Co

LOCAL AUTHORITY

Hounslow

TENURE

Freehold

COUNCIL TAX BAND

VIEWINGS

By prior appointment only

Energy Efficiency Rating		Current	Potential
Very energy efficient - lower running costs			
(92 plus) A			84
(81-91) B			
(69-80) C			
(55-68) D		62	
(39-54) E			
(21-38) F			
(1-20) G			
Not energy efficient - higher running costs			
England & Wales		EU Directive 2002/91/EC	

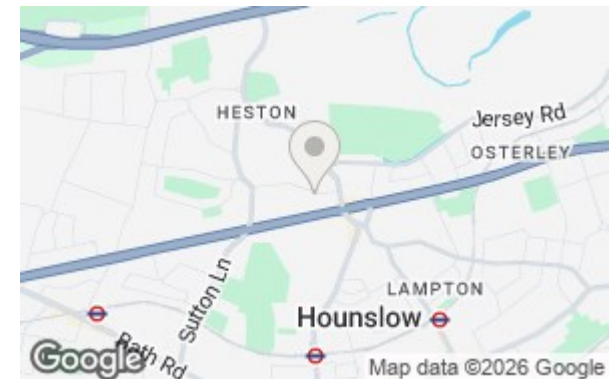

Agents Note: Whilst every care has been taken to prepare these particulars, they are for guidance purposes only. All measurements are approximate and are for general guidance purposes only and whilst every care has been taken to ensure their accuracy, they should not be relied upon and potential buyers/tenants are advised to recheck the measurements

Shaw
& Co
ESTATE
AGENTS

OFFICE ADDRESS
10 Central Parade
New Heston Road
Heston
Middlesex
TW5 0LJ

OFFICE DETAILS
0208 570 7258
heston@shawandcoestates.com